

# Welcome to Reno/Sparks

## Relocation Guide 2021



# CONTENTS

## GENERAL INFORMATION

HOME MEANS NEVADA  
AREA PROFILE  
DOWNTOWN RENO DISTRICTS  
SPARKS SPOTLIGHT  
WHY NEVADA?  
NEVADA TAX ADVANTAGES  
RENO/SPARKS ECONOMY  
NEVADA ECONOMIC GROWTH  
TAHOE RENO INDUSTRIAL CENTER  
RENO TECHNOLOGY PARK  
EDUCATION  
UNIVERSITY OF NEVADA, RENO  
DEMOGRAPHICS



## LOCAL SERVICES

QUICK REFERENCE GUIDE  
LOCAL SERVICES/MEDICAL FACILITIES  
CHILDCARE & YOUTH SERVICES  
SENIOR RESOURCES  
PET & ANIMAL SERVICES  
LOCAL CHURCHES & FAITH CENTERS  
HEALTH CLUBS  
TRANSPORTATION



## THINGS TO DO

SPECIAL EVENTS  
2021 SPECIAL EVENTS  
GOLF COURSES  
WINTER RECREATION  
TAHOE AREA RESORTS  
PARKS & RECREATION  
NEVADA STATE PARKS  
PLACES TO EAT  
SHOPPING  
FUN STUFF FOR KIDS



# GENERAL INFORMATION



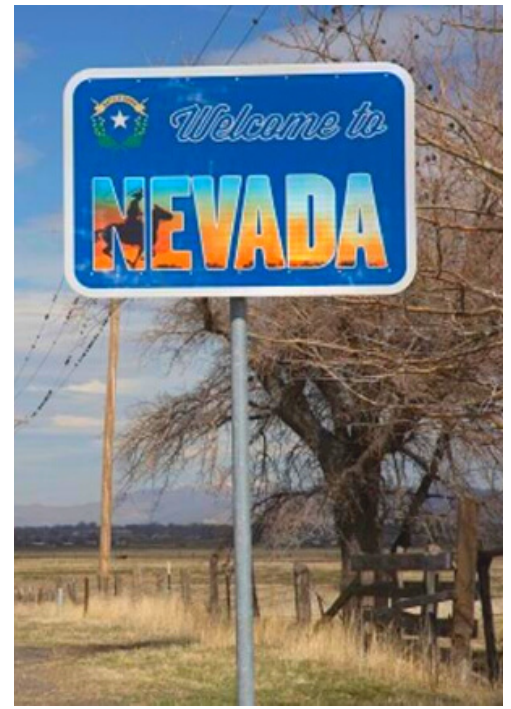

# Home Means NEVADA

**Entered the Union:** October 31, 1864 (36th)

**Capital:** Carson City

**Origin of Name:** Spanish for "snow-covered"

**State Motto:** All for Our Country

**State Nicknames:** Sagebrush State \* Silver State \* Battle Born State

**State Song:** "Home Means Nevada"

**National Forests:** 2 **State Parks:** 23

**Famous for:** Gambling, Lake Tahoe, Reno, Las Vegas, Gold & Silver Mining, Wild Mustangs and Outdoor Recreation

## FUN FACTS

- Nevada was made famous by the 1859 discovery of the Comstock Lode, the richest known U.S. silver deposit.
- Nevada is the largest gold-producing state in the nation. It is second in the world behind South Africa.
- Nevada is the gambling and entertainment capital of the United States.
- Las Vegas has more hotel rooms than any other place on earth.
- Most of the state is desert but the Sierra Nevada mountain range near Reno and the Ruby Mountains near Elko have snow for half the year.
- Nevada has more mountain ranges than any other state, with its highest point at the 13,145 foot top of Boundary Peak near the west central border.
- About 150 couples get married in Las Vegas each day.
- In 1899 Charles Fey invented a slot machine named the Liberty Bell. In 1999 Nevada had 205,726 slot machines, one for every 10 residents.

## STATE SYMBOLS

**Bird:** Mountain Bluebird

**Tree:** Bristlecone Pine

**Flower:** Sagebrush

**Animal:** Desert Bighorn Sheep

**Colors:** Silver & Blue

**Metal:** Silver

**Rock:** Sandstone

**Fish:** Lahontan Cutthroat Trout

**Fossil:** Ichthyosaur

**Grass:** Indian Ricegrass





# Area Profile

**Located in the majestic Sierra Nevada Mountains**, the breathtaking Reno-Sparks Lake Tahoe area is not your average destination. From the arts to the cultural splendor, from the casinos to its unprecedented natural surroundings, the Reno-Sparks area is rich in both tradition and fresh entertainment.

**Minutes away from world-famous Lake Tahoe**, the Reno-Sparks community is surrounded by natural beauty and limitless recreational opportunities. The Reno-Sparks Lake Tahoe region has over 18 world-class ski resorts, many just a short 45-minutes from downtown, and 40-plus golf courses. The area also boasts 60 gaming locations, the National Bowling Stadium, the National Automobile Museum, Rancho San Rafael Park's Arboretum and Wilbur D. May Great Basin Adventure, the historic boomtown of Virginia City, and world-class fishing, hiking, biking, and numerous other outdoor activities. The quality of life in the Reno-Sparks area is tough to beat.

**At 4,500 feet altitude**, the Reno-Sparks area offers four distinct seasons with few extremes. Average temperatures range from winter lows in the 20's to summer highs in the 90's. Low humidity characterizes the area, making the cool days seem not so cold and the warm days not so hot. Rain is scarce, and snow is certain. Here the sun shines more than 300 days a year.

## NORTHERN NEVADA CLIMATE

TEMP	HIGH	LOW
ANNUAL	67.4	35.2
JANUARY	45.5	21.8
APRIL	64.1	33.2
JULY	91.2	51.4
OCTOBER	69.9	34

## DISTANCES TO OTHER WESTERN CITIES

CITY	MILES	AIRTIME
LAS VEGAS	441	1:00
LOS ANGELES	475	1:06
PHOENIX	753	2:00
PORTLAND	586	1:30
SACRAMENTO	135	:25
SALT LAKE CITY	526	1:00
SAN FRANCISCO	231	:50



# Downtown Reno Districts



There is a renaissance in Downtown Reno! The swelling tide of enthusiasm, energy and investment has created an environment for adaptive reuse of property, new businesses, historical preservation and improved residential areas and arts and cultural activities. Downtown Reno as a whole and its unique connected districts have been featured in AAA, Via, New York Magazine and Sunset Magazine  
- Northern Nevada Business Weekly

MIDTOWN

THE ARCH  
DISTRICT

UNIVERSITY  
DISTRICT

RIVERWALK  
DISTRICT

LIBERTY  
DISTRICT

WELLS DISTRICT

OLD BREWERY  
DISTRICT

## Highlights

- Whitewater Park
- Masonic, Bruka & Lear Theatre
- Hub for ARTown Festival
- National Bowling Stadium
- Old Lincoln Hwy
- Reno Bike Project
- Start-up Row
- National Automobile Museum
- Reno Aces Ballpark
- Nevada Museum of Art
- Discovery Museum
- Unique locally owned businesses
- Multicultural businesses





# Sparks Spotlight

Since the 1990's, Sparks has grown tremendously, offering residents and visitors a wide variety of services and activities. Sparks was reported as the fastest growing city in Nevada between 1999-2008 and continues to grow. Quality of life is cited as one of the main reasons people relocate to the Sparks area.

Sparks is known as the premiere special events venue for all of Northern Nevada with attractions on the Victorian Square bringing thousands of visitors to annual events such as Hometown Farmer's Market, Hot August Nights, Best in the West Nugget Rib Cook Off and Hometown Christmas. Victorian Square is now also home to the new Nugget Events Center which is a 8,517 seat venue for concerts.

## Highlights

- **Victorian Square**
- **Sparks Marina**
- **Legends Shopping Center**
- **Scheels**
- **Golden Eagle Sports Complex**
- **Nugget Events Center**





# Why Nevada?

**Current Washoe County Population: 471,519**

**Cost of Living:**

**Median Reno-Sparks Home Price: \$429,500**

**Median Reno-Sparks Rent Price: \$1,795/mo**



## Region's Largest Non-Gaming Employers:

1. Washoe County School District
2. University of Nevada, Reno
3. Washoe County
4. Renown Medical
5. International Game Technology (IGT)

## Reno-Sparks Key Industries:

1. Advanced Manufacturing
2. Distribution, Logistics & E-Commerce
3. Back Office, Business Support & Data Centers
4. Clean Energy
5. Financial Services
6. Aerospace & Defense

## Reno Business and Gaming

When people think of Reno, they think of gambling. However, over the last couple of decades, Reno and Sparks have become much more than just gaming cities. With many prominent corporations residing in the area, INC magazine rated Reno as the sixth best spot to do business for a mid-sized city.

## Advantages of Doing Business in Nevada

- Stockholders, directors and officers do not need to live or hold meetings in Nevada.
- Directors do not need to be stockholders.
- Officers and directors of a Nevada Corporation can be protected from personal liability for lawful acts of the corporation.
- Nevada corporation may purchase, hold, sell or transfer shares of its own stock.

## SALES TAX RATE

<b>Carson County</b>	<b>7.60</b>
<b>Churchill County</b>	<b>7.60</b>
<b>Clark County</b>	<b>8.38</b>
<b>Douglas County</b>	<b>7.10</b>
<b>Lyon County</b>	<b>7.10</b>
<b>Storey County</b>	<b>7.60</b>
<b>Washoe County</b>	<b>8.27</b>

## US Best States for Doing Business

State of Nevada ranked #6 from the Chief Executive's annual survey that asked over 600 CEO's to grade each state on the following criteria:

- *Taxation & Regulation*
- *Workforce & Quality*
- *Living Environment*

*Courtesy of EDawn & Northern Nevada Business*





# Nevada Tax Advantages

**How does no state income tax sound? To many it has sounded like a great reason to make Nevada home.**

**The requirements are simple, and the benefits can be quite impressive.**

The main qualifier for this tax "hospitality" is to make Nevada your central place of residence. This does not mean you cannot do business or even have residences in other states, just that Nevada is the state in which you have the closest ties.

If you are residing in Nevada and become a Nevada resident, you will generally escape state income taxes, except for income that arises from sources within another state.

Even if you are required to "source" part of your income from a state that has an income tax, you may still enjoy a significant decrease in your overall tax burden.

**Below are a few reasons why you should consider Nevada for your home and business:**

- No personal income tax
- No corporate income tax
- No gross receipts tax
- No franchise tax
- No inventory tax
- No tax on issuance of corporate shares
- No requirements of shareholders and directors to live in Nevada
- No tax on sale or transfer of shares
- No succession or inheritance with IRS
- Simple annual requirements
- Protection for Directors and Officers
- No initial or minimum capital requirements
- Anonymity of owners-total privacy
- Low property taxes
- Business friendly environment



# Reno-Sparks Economy

The Reno-Sparks Economy is principally based in the trade and service sector, with approximately 65% of the work force employed in these occupations. Although gaming and other recreational activities represent a significant of the growing economy and assessed valuation, the City is experiencing a gradual diversification of its business base with the expansion of distribution, warehousing, and manufacturing facilities. Approximately 25% of the workforce is employed in the fields of construction, manufacturing, transportation, communications, public utilities, and finance related services.

The Reno-Sparks area is serviced by two major highways. Union Pacific Railroad and a number of trucking and airline carriers. This makes it possible to ship from Reno to 80% of the 11 western states on a next-day basis.

Nevada has no corporate or personal income tax, and is a right-to-work state. These factors have contributed to the state's tremendous growth in the 1990's and into the 2000's.

In addition to the accomplishments of the Economic Development Authority of Western Nevada in bringing new business to Northern Nevada, the City of Reno Economic and Redevelopment Agency has begun both entertainment and housing projects for in the City's downtown sector.

Over thirty million dollars of City and one billion dollars in private/other public investment has been made in downtown Reno to modernize and beautify infrastructure and facilities. A maintenance district was established to ensure that the downtown area will remain clean and beautiful. The City also established a police district downtown to ensure a safer environment.

City of Reno	<a href="http://www.reno.gov">www.reno.gov</a>	775-334-4636
City of Sparks	<a href="http://www.cityofsparks.us">www.cityofsparks.us</a>	775-353-5555
Washoe County	<a href="http://www.washoecounty.us">www.washoecounty.us</a>	775-328-2000
State of Nevada	<a href="http://nv.gov">http://nv.gov</a>	Various Listings
Nevada Department of Taxation	<a href="http://tax.nv.gov">http://tax.nv.gov</a>	1-866-962-3707
Nevada Secretary of State	<a href="http://www.nvsos.gov">www.nvsos.gov</a>	775-684-5708
Nevada Association of Employers	<a href="http://www.nae-online.org">www.nae-online.org</a>	775-329-4241
Reno-Sparks Chamber of Commerce	<a href="http://www.thechambernv.org">www.thechambernv.org</a>	775-636-9550
Reno-Sparks Convention & Visitor's Authority	<a href="http://www.visitrenotahoe.com">www.visitrenotahoe.com</a>	800-367-7366
Economic Development Authority	<a href="http://www.EDAWN.org">www.EDAWN.org</a>	775-829-3700
Job Opportunities in Nevada	<a href="http://www.join.org">www.join.org</a>	775-785-6106
Center for Regional Studies (UNR)	<a href="http://www.centerforregionalstudies.org">www.centerforregionalstudies.org</a>	775-784-1771
Small Business Department (UNR)	<a href="http://www.nsbdc.org">www.nsbdc.org</a>	800-240-7094



# Northern Nevada Economic Growth

## The following companies are making Northern Nevada their home

### 4 New Companies Bring More Than 600 Jobs to the Region

RENO, Nevada (August 12, 2020) – The Economic Development Authority of Western Nevada (EDAWN) announced four new companies to the Northern Nevada region at a live-stream press conference held today. More than 600 jobs will be created including blockchain software development, business development, engineering, marketing, warehouse operations, career consulting, and more.

#### Discover Podium

Discover Podium is a technology-driven SAAs company whose platform is dedicated to delivering career advancement solutions for leaders in transition. The company expects to double its staff over the next year and is projected to reach 300 employees over the next five years at an average wage of \$80,000.

#### Unstoppable Domains

Unstoppable Domains is a rising U.S. startup, launching domain names on blockchain technology. The domain names can be used for both payments and websites. The startup is backed by one of the leading U.S. venture capital firms, Draper Associates and is an entry point for the emerging decentralized web, the next evolution of the internet. “Reno was an obvious choice to headquarter Unstoppable,” said Matthew Gould, Co-Founder of Unstoppable Domains.

#### Mary Kay

Mary Kay is one of the most recognized beauty brands in the world and is a multi-billion-dollar company with products in nearly 40 countries throughout the world. With over 1,500 product and technology patents, Mary Kay has paved the way for millions of female entrepreneurs. The new Reno distribution facility will have 50 employees at build-out and is expected to be operational in September.

#### theBalm

theBalm has cosmetics down to a fine art-timeless, versatile, always picture perfect and is committed to creating premium cosmetics at an accessible price, since 2004. The company is relocating its corporate headquarters from California to Reno with plans to fill 200 positions at its new distribution facility and has a cap ex investment of approximately \$5,000,000.



### New Innovative Companies Lead Northern Nevada’s Economic Recovery

RENO, Nevada (June 10, 2020) – The Economic Development Authority of Western Nevada (EDAWN) announced three new companies to the Northern Nevada region at a live-stream press conference today. A combined 340 jobs will be created in the areas of software development, CRM platform development, data analysis and more. A significant number of these positions offer wages over \$30/hour. Innovative companies such as these are a key factor toward leading the region’s economic recovery.

#### PlusPlus

PlusPlus, a software platform that allows companies like SalesForce, LinkedIn and Shopify to scale their internal learning and development programs, is expanding to Reno, with the aid of an investment received from the Reno Seed Fund (RSF). The company plans to hire 100 employees over the next five years, in sales, marketing and customer success, with an average annual base salary of \$70,000.

#### YOGO

YOGO offers eco-friendly, compact yoga mats focused on performance and design. The company aims to make yoga a simpler, convenient and beautiful experience using natural materials and low waste design. YOGO has moved both their operations and corporate office here with plans to hire up to 40 employees at their new location in Sparks, Nevada.

#### Affinity Development Group

Affinity Development Group (ADG) specializes in developing affinity and Customer Relationship Management programs for many high profile clients. The scope of services offered include program assessment, strategic planning, business process and workflow development, product fulfillment, database integration/management, data mining and much more.



# Northern Nevada Economic Growth

The following companies are making Northern Nevada their home

## New Co-Headquarters Brings Blockchain Jobs to Reno

RENO, Nevada (Sep. 5, 2019) – The Economic Development Authority of Western Nevada (EDAWN) announced that BlocWatch, a blockchain monitoring and management platform, is establishing its co-headquarters in Reno, with the aid of an investment received from the Reno Seed Fund (RSF). The fund raised and co-invested \$730k of the \$6 million seed round preferred stock. “While successfully building multiple software companies, we have come to appreciate the unique advantages provided by locating in a market such as Reno,” said Aaron Klein, CEO/Co-founder of BlocWatch. “Not only are Reno’s employer costs fractional when compared to San Francisco, Seattle, or New York City, but it also provides a talented workforce, affordable housing, and a supportive community. We relish the opportunity to build BlocWatch while our current and future employees enjoy the advantages of living in Reno and its surrounding areas.”



## Victory Logistics District Master Planned Industrial Development in Fernley NV

Fernley, NEVADA (July 16, 2019) – Mark IV Capital announces its acquisition of the Crossroads Commerce Center in Fernley, Nevada with the help of Brett Edwards and Rex Massey of CBRE. The 4,300-acre property has been re-branded to Victory Logistics District. The acquisition was completed in partnership with Heath Rushing of New Nevada Resources, and the project is anticipated to be the region’s premier Class-A distribution, manufacturing and commercial center. Victory Logistics District is approximately 30 miles east of Reno and just 15 miles east of the Tahoe Reno Industrial Center, which has been virtually sold out to users.



## New Co-Headquarters Bringing Innovative and Tech-Driven Jobs to Reno

RENO, Nev. (April 25, 2019) – MOBE®, an innovative health solutions company, is establishing its co-headquarters in downtown Reno. The company plans to create up to 300 highly skilled jobs over the next three to five years. Many of the positions will be high-paying with career track positions in health care innovation, digital solutions, data science, and consumer engagement. The company expects to open its Reno office by Q3 2019.



## A Region For Business.

Start growing in Greater Reno-Sparks-Tahoe

No matter your business Greater Reno-Sparks-Tahoe is the region for you to move or grow your company. From central access to the 11 western states, to tax and business-friendly policies, a skilled workforce and the quality of life to keep them here, Greater Reno-Sparks-Tahoe can deliver.



ECONOMIC DEVELOPMENT AUTHORITY  
OF WESTERN NEVADA

#1 Highest Startup Density for MSA size class.

#3 Most Business Friendly Tax Climate

#9 Top 100 Best Places to Live

For a complete list of companies moving into the Northern Nevada area, please visit [edawn.org/news](http://edawn.org/news)





# Tahoe Reno Industrial Center

**Tahoe Reno Industrial Center (TRIC)** is the largest industrial park in the world. Currently we have over 15,000 acres pre-zoned, fully entitled, and in active development. Sites are still available but are going fast.

Not only is Tesla Gigafactory 1 located here, but many of the foremost tech companies in the world, such as Blockchains, Google, Jet.com, and Switch have recognized the unique location, development and business benefits of this park.

## **Benefits of the Tahoe Reno Industrial Center include:**

- The vast majority of industrial uses are pre-approved; rarely are special use permits ever required
- Grading permits issued within 7 days of application
- Building permits issued within 30 days of application. Yes, you read that right! Just imagine, you could have your site graded, built and open for business within 180 days following close of escrow.
- Roads and all utilities (power, gas, fiber, water, wastewater, reclaimed water) are in place and built for industrial capacity.
- A Berkshire Hathaway owned power plant is in the park with a capacity of 1100 megawatts
- Ample water rights secured and banked
- 12 Miles of dedicated frontage on the I-80 corridor and Union Pacific Intercontinental rail line, which is the central logistics corridor to and from the east coast
- Located in Nevada where there is ZERO state income tax!
- All land in the development is owned free and clear

The park built 14 million square feet of buildings in its first 16 years. With such tenants such as Tesla, Walmart, PetSmart, Toys R' Us, eBay, Diapers.Com, Dell and U. S. Ordinance who have already made the decision to locate within the Tahoe/Reno Industrial Center and another 10 million square feet of additional tenants signed recently, it is on its way to be the largest industrial complex in the world. With more major tenants scheduled to announce relocation to the Tahoe/Reno industrial center, it should produce over 100,000 new jobs to the Northern Nevada region.





# Tesla Battery Gigafactory

Tesla broke ground on the Gigafactory in June 2014 outside Sparks, Nevada. The name Gigafactory comes from the word 'Giga,' the unit of measurement representing “billions.” The Gigafactory is being built in phases so that Tesla can begin manufacturing immediately inside the finished sections and continue to expand thereafter. Already, the current structure has a footprint of more than 1.9 million square feet, which houses more than 4.9 million square feet of operational space across several floors. Still, the Gigafactory is about 30 percent done. Once complete, Tesla expects the Gigafactory to be the biggest building in the world – and entirely powered by renewable energy sources. Designed to be a net zero energy factory upon completion, the facility will be primarily powered by solar, and installation is already underway. In mid-2018, battery production at Gigafactory 1 reached an annualized rate of roughly 20 GWh, making it the highest-volume battery plant in the world. Tesla currently produces more batteries in terms of kWh than all other carmakers combined. With the Gigafactory ramping up production, Tesla’s cost of battery cells will significantly decline through economies of scale, innovative manufacturing, reduction of waste, and the simple optimization of locating most manufacturing processes under one roof. By reducing the cost of batteries, Tesla can make products available to more and more people, allowing us to make the biggest possible impact on transitioning the world to sustainable energy.

Source: <https://www.tesla.com/gigafactory>

## A look at the \$100 billion estimated economic impact from the Tesla Gigafactory:

- 6,500 direct factory employees earning an average wage above \$25 an hour
- 3,000 construction jobs
- \$1.5 billion indirect tax revenue generated over 20 years
- \$400 million direct tax revenue generated beginning in 2024
- 16,000 indirect jobs once the factory is up and running
- Overall job creation equal to 2 percent of state's workforce and 11 percent of the region's workforce
- A 4 percent increase in the state's GDP is expected and the region's economic output is expected to jump by 20 percent

Source: Governor's Office of Economic Development



# Switch TAHOE RENO

The world's largest, most advanced data center campus is now located in Reno/Sparks' backyard. The first building in Switch's Citadel Campus officially opened at the Tahoe Reno Industrial Center in late February of 2017. It is known as "Tahoe Reno 1," the 130-megawatt facility is one of several data center buildings planned for the project. The Citadel Campus is Switch's response to the increasing demand for internet-connected people, services and devices. It is designed to be the world's largest data center campus built on the same designs as the campus in Las Vegas. Before Tahoe Reno 1 came about, the title of the largest single data center building belonged to the Lakeside Technology Center located in Chicago.

JASON HIDALGO- RENO GAZETTE JOURNAL

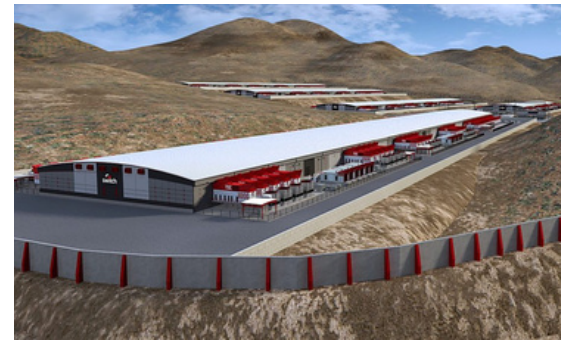

## Google in Northern Nevada

Google's Northern Nevada facility is shaping up to be a large undertaking as construction picks up at the 1,210-acre site inside Tahoe Reno Industrial Center. There is plenty of construction activity at the site on USA Parkway just a few miles south of the Switch Citadel data center campus and Tesla Gigafactory in Storey County. The frame of a two-story structure surrounded by cranes and other construction equipment can be seen at the site, which Google bought for \$29.1 million in April 2017. Google has yet to provide specific details about the facility, which is expected to be a data center.

Google bought the facility as part of a \$13 billion investment that the company was making across the United States, including in Nevada. At the time, CEO Sundar Pichai indicated that Google will be making major expansions in 14 states. "These new investments will give us the capacity to hire tens of thousands of employees, and enable the creation of more than 10,000 new construction jobs in Nebraska, Nevada, Ohio, Texas, Oklahoma, South Carolina and Virginia," Pichai wrote in Google's official blog. "With this new investment, Google will now have a home in 24 total states, including data centers in 13 communities."

JASON HIDALGO- RENO GAZETTE JOURNAL





# Reno Technology Park

The Reno Technology Park was envisioned by a team of developers called Unique Infrastructure Group.

The property provides access to a wide variety of energy sources, including hydroelectric, wind and geothermal power. RTP is ideally located along the I-80 'fiber way,' directly across the from the Tahoe Reno Industrial Center. Large Nevada electric customers such as data centers can access the western wholesale power market to negotiate some of the lowest power prices in the region. The 2012 Nevada legislature reaffirmed an array of tax advantages that match or exceed any available in the U.S. When combined Nevada's lack of a corporate income tax, the Reno Technology Park stands out as the exceptional location for data center development in the Western U.S.

The Reno/Tahoe region is consistently ranked as one of the locations having the highest quality of life in the country. Reno's very low cost of living and Nevada's lack of a personal income tax facilitate recruiting and retention of essential personnel.

- World class fiber
- An unmatched financial environment
- Deregulated, low cost power
- "Business friendly" state of Nevada
- Experienced, ready IT workforce
- Direct access to all tier 1 providers
- 10Gb/s, 40Gb/s and 100 Gb/s service and DWDM transport
- 350 MW of import capacity
- Multiple kv and 345 kv trans-mission lines
- Independence from any single utility
- No state corporate income tax
- No tax on digital software
- No state personal income tax



Apple says construction on the East Campus of the Northern Nevada Data Center is finished. The data center has 50 large rooms, filled with servers. They allow people to do every day communication with their devices, including sending text messages and using iCloud. "Whenever anyone calls on Siri from California and Nevada, the servers here answer that call," Kristina Raspe, Vice President of Apple Real Estate Development said. Last year, Apple announced a five-year plan to invest \$10 billion into its US data centers. With the completion of the East Campus, it will start construction on the West Campus within the next year, growing its facility to 1.2 million square-feet.



# Education



## HOW TO REGISTER

---

Any student NEW to the Washoe County School District (WCSD) must present a birth certificate and an immunization record from your health care provider. A utility bill may be necessary for proof of residency, and the student's Social Security number also is requested. High school students younger than 18 need to be accompanied by a parent or legal guardian in order to register. If you are not sure which school your child should attend, call the Zoning Office at 348.0200 or visit <http://buses.washoeschools.net>.

### Immunizations

For information on Immunization clinics call 328-2441. Immunizations are required for children attending Washoe County schools. Make sure your child's immunizations are up to date. Bring your child's shot record.

### The following clinics offer immunizations:

- Washoe County Health Department - 775.328.2441
- Health Access Washoe County - 775.770.6035

### Washoe County School District - [www.washoeschools.net](http://www.washoeschools.net) - 775.348.0200

The Washoe County public schools offer a superior education to 64,000 students in over 90 schools. The students mirror the excellent programs and curriculum offered by consistently scoring above state and national norms in standardized achievements tests as well as college entrance exams.

The District offers a full spectrum of curricular offerings from special education to gifted and talented at all schools. It offers special programs in alternative education for at-risk students, drug education and for all students an aggressive program in sex and AIDS education. Offerings in forensics, music and art help prepare students for future life. The high schools offer over 60 extracurricular activities for both girls and boys.

## PRIVATE SCHOOLS

---

**Little Flower Elementary**  
1300 Casazza Drive  
775.323.2931  
[www.littleflowerschoolnv.org](http://www.littleflowerschoolnv.org)

**Mountain View Montessori**  
565 Zolezzi Lane  
775.852.6162  
[www.mountainviewmontessori.com](http://www.mountainviewmontessori.com)

**Bishop Manogue Catholic High School**  
110 Bishop Manogue Drive  
775.336.6000  
[www.bishopmanogue.com](http://www.bishopmanogue.com)

**Brookfield School**  
6800 S. McCarran Blvd  
775.825.0257  
[www.brookfieldschool.com](http://www.brookfieldschool.com)

**Excel Christian School**  
850 Baring Blvd  
775.356.9995  
[www.excelchristianschool.com](http://www.excelchristianschool.com)

**Sage Ridge School**  
2515 Crossbow Court  
775.852.6222  
[www.sageridge.org](http://www.sageridge.org)

**Truckee Meadows Christian Academy**  
3940 Spring Drive  
775.823.9002



# Education



## UNIVERSITIES AND COLLEGES

**Truckee Meadows Community College**  
7000 Dandini Blvd  
775.673.7111  
[www.tmcc.edu](http://www.tmcc.edu)

**Western Nevada College**  
2201 W. College Parkway  
775.445.3000  
[www.wnc.edu](http://www.wnc.edu)

**Career College of Northern Nevada**  
1421 Pullman Drive  
775.856.2266  
[www.ccnn.edu](http://www.ccnn.edu)

**Academy of Arts, Careers & Technology**  
380 Edison Way  
775.327.3920  
[www.washoeschools.net/aact](http://www.washoeschools.net/aact)

**Sierra Nevada College**  
999 Tahoe Boulevard  
775.831.1314  
[www.sierranevada.edu](http://www.sierranevada.edu)

**Desert Research Institute**  
2215 Raggio Parkway  
775.673.7300  
[www.DRI.edu](http://www.DRI.edu)

## CHARTER SCHOOLS

**Academy for Career Education**  
Grades: 9-12  
2800 Vassar Street, Reno  
775.324.3900 - [www.acehighschool.org](http://www.acehighschool.org)

**Bailey Charter Elementary School**  
Grades: K-6  
210 Gentry Way, Reno  
775.323.6767 - [www.baileycharter.org](http://www.baileycharter.org)

**Coral Academy of Science**  
Grades: K-12  
1701 Valley Rd, Reno  
775.322.0274 - [www.coralacademy.org](http://www.coralacademy.org)

**High Desert Montessori School**  
Grades: infant/toddler-8  
2590 Orovada St, Reno  
775.624.2800 - [www.hdmsreno.com](http://www.hdmsreno.com)

**Mariposa Dual Language Academy**  
Grades: K-5  
3875 Glen Street, Reno  
775.826.4040 -  
[www.mariposaacademy.net](http://www.mariposaacademy.net)

**Encompass Academy Charter HS**  
Grades: 9-12  
121 Vesta Street, Reno  
775.322.5566  
<http://rainshadowcharterhs.com>

**Sierra Nevada Academy**  
Grades: K-8  
13880 Stead Boulevard, Reno  
775.677.4500 x13 - [www.snacs.org](http://www.snacs.org)

### State Sponsored Charter Schools:

**Alpine Academy High School**  
Grades: 9-12  
605 Boxington Way, Suite 112,  
Sparks  
775.356.1166 -  
[www.alpineacademy.net](http://www.alpineacademy.net)

**Nevada Connections Academy**  
(Distance Education)  
Grades: K-12  
555 Double Eagle Ct, Suite 2000  
775.826.4200 x325  
[www.connectionsacademy.com](http://www.connectionsacademy.com)



# WCSD Infrastructure Plan

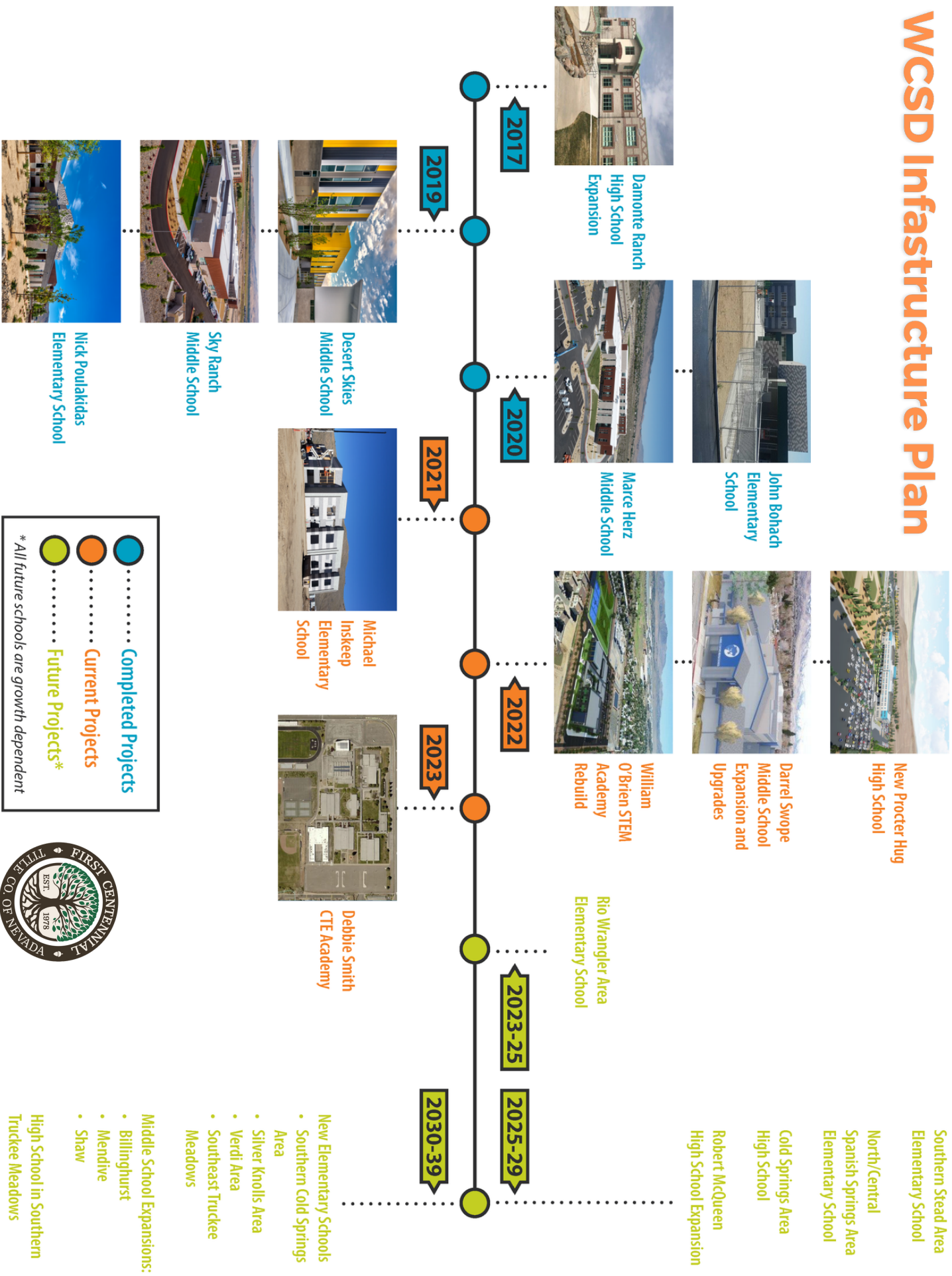

● Completed Projects  
● Current Projects  
● Future Projects\*  
 \* All future schools are growth dependent





# University of Nevada, Reno

**The University of Nevada, Reno** is the state's historic flagship institution of higher education. The University has a student enrollment of more than 16,000, including about 3,200 graduate students, and a total budget of nearly \$500 million.

The University provides a broad range of programs and degree options, ranging from baccalaureate degrees in more than 75 disciplines to more than 100 graduate-degree programs at the master's and doctoral level. The University of Nevada School of Medicine is a vital component of the University, with campuses in both of Nevada's major urban centers, Las Vegas and Reno, and a health network that extends to much of rural Nevada. The University of Nevada was founded in 1874 in Elko as the state's first institution of higher education. Relocated to Reno in 1887, the University remained the state's only institution of higher education for 75 years. The first building on the Reno campus, Morrill Hall, is still in use today, and the campus has grown from a small cluster of buildings surrounding a central quadrangle (modeled after Thomas Jefferson's design for the University of Virginia), to a 250-acre site just north of downtown Reno. The University is one of eight institutions of higher education governed by the Nevada System of Higher Education.

The University has 76 undergraduate degree programs, and more than 100 graduate degree programs (66 master's and 37 doctoral programs) from which students may choose. New majors approved recently include Atmospheric Sciences, Environmental Science, Forest and Rangeland Management, Wildlife Ecology, and Computer and Information Engineering. The University is also in the process of adding new Ph.D. programs in Mathematics, Statistics, and Geography, and a new interdisciplinary undergraduate program in Environmental Studies.

The tuition for Nevada resident undergraduates is among the lowest in the western United States and is a reflection of the Board of Regents' and state legislature's policy to provide access to as many Nevada high school graduates as are qualified. For example, the resident undergraduate tuition and fees total \$2,850, which is lower than all but one of 15 western states. Non-resident undergraduate tuition and fees total \$11,524 which is at the median for the western states.

Coupled with its status as a land-grant institution, the University necessarily has a statewide mission and boasts programs and activities in all 17 counties of the state. It has more than 700 employees outside the Reno area, most of them in Las Vegas. It plays a critical role in the promotion of health throughout the state through its Schools of Medicine, Nursing, and Public Health.

The University's athletics programs compete in NCAA Division I as part of the Mountain West Conference. The University fields competitive teams in 18 sports, with six men's sports and 9 women's sports teams offering scholarships.



# THE UNIVERSITY OF NEVADA, RENO

A university on the move is making this region a **smart choice for business.**

## National Tier 1



university, as reported by *U.S. News & World Report's* "Best Colleges" issue. This competitive ranking places Nevada among the nation's top universities.

## Top 25

in the nation for best part-time MBA program, as recognized by *Bloomberg Businessweek*.

# 140



years... that's how many years the University of Nevada has been the state's Land-Grant university. Today, we continue this proud tradition by serving citizens in every county of the Silver State.

# \$350 Million

in new state-of-the-art facilities added in the last 6 years.

# 124%

increase in the number of enrolled National Merit and Presidential scholars from 2009 to 2013.

## Tech Transfer

The University's Technology Transfer Office helps to create new companies and industries by commercializing University research and innovation.

## Shaking Up Engineering

Nevada's Large-Scale Structures Lab is America's largest earthquake engineering research facility.

## World-Improving Research

From advances in neuroscience to high-energy physics to solutions for climate change, Nevada is leading the charge.

## 13 Alumni In Congress

With 13 alumni having served in the U.S. Congress, the University has a long legacy of leadership at the highest levels.

## A SMART CHOICE FOR RESEARCH, DEVELOPMENT AND INNOVATION

With **\$93 million in current research activity**, the University is perfectly positioned to help businesses with research, consulting, and joint ventures. The University recently launched an **Unmanned Aerial Systems (UAS) minor program** to support Nevada's designation as an **FAA-approved UAS center**, and is working to achieve industry-University partnerships to commercialize fixed, aerial, and underwater robotic systems and advanced manufacturing systems.

Technology Transfer Office  
(775) 784-4421



University External Relations  
(775) 784-4805

University of Nevada, Reno



# Washoe County Demographics

People	Washoe County, NV	UNITED STATES
<b>Population</b>		
Population estimates, July 1, 2019, (V2019)	471,519	328,239,523
Population estimates, April 1, 2010, (V2019)	421,429	308,758,105
Population, percent change - April 1, 2010 (estimates base) to July 1, 2019, (V2019)	11.9%	6.3%
Population, Census, April 1, 2010	421,407	308,745,538
<b>Age and Sex</b>		
Persons under 5 years, percent	5.8%	6.0%
Persons under 18 years, percent	21.3%	22.3%
Persons 65 years and over, percent	16.8%	16.5%
Female persons, percent	49.5%	50.8%
<b>Race and Hispanic Origin</b>		
White alone, percent	84.6%	76.3%
Black or African American alone, percent,	2.8%	13.4%
American Indian and Alaska Native alone, percent	2.2%	1.3%
Asian alone, percent	5.8%	5.9%
Native Hawaiian and Other Pacific Islander alone	0.7%	0.2%
Two or More Races, percent	3.9%	2.8%
Hispanic or Latino, percent	25.0%	18.5%
White alone, not Hispanic or Latino, percent	62.3%	60.1%
<b>Population Characteristics</b>		
Veterans, 2014-2018	32,528	18,611,432
Foreign born persons, percent, 2014-2018	14.0%	13.5%
<b>Housing</b>		
Housing units, July 1, 2019, (V2019)	205,417	139,684,244
Owner-occupied housing unit rate, 2014-2018	58.0%	63.8%
Median value of owner-occupied housing units, 2014-2018	\$299,400	\$204,900
Median selected monthly owner costs -with a mortgage, 2014-2018	\$1,589	\$1,558
Median selected monthly owner costs -without a mortgage, 2014-2018	\$459	\$490
Median gross rent, 2014-2018	\$1,000	\$1,023
Building permits, 2019	5,251	1,386,048



# Washoe County Demographics

People	Washoe County, NV	UNITED STATES
<b>Families and Living Arrangements</b>		
Households, 2014-2018	177,632	119,730,128
Persons per household, 2014-2018	2.50	2.63
Living in same house 1 year ago, percent of persons age 1 year+, 2014-2018	81.1%	85.5%
Language other than English spoken at home, percent of persons age 5 years+, 2014-2018	23.4%	21.5%
<b>Education</b>		
High school graduate or higher, percent of persons age 25 years+, 2014-2018	88.3%	87.7%
Bachelor's degree or higher, percent of persons age 25 years+, 2014-2018	30.5%	31.5%
<b>Health</b>		
With a disability, under age 65 years, percent, 2014-2018	8.6%	8.6%
Persons without health insurance, under age 65 years, percent	12.5%	10.0%
<b>Economy</b>		
In civilian labor force, total, percent of population age 16 years+, 2014-2018	66.0%	62.9%
Total accommodation and food services sales, 2012 (\$1,000)	1,860,761	708,138,598
Total manufacturers shipments, 2012 (\$1,000)	6,427,397	5,696,729,632
Total merchant wholesaler sales, 2012 (\$1,000)	6,401,901	5,208,023,478
Total retail sales, 2012 (\$1,000)	6,167,020	4,219,821,871
Total retail sales per capita, 2012	\$14,345	\$13,443
<b>Transportation</b>		
Mean travel time to work (minutes), workers age 16 years+, 2014-2018	21.6	26.6
<b>Income and Poverty</b>		
Median household income (in 2018 dollars), 2014-2018	\$61,155	\$60,293
Per capita income in past 12 months (in 2018 dollars), 2014-2018	\$33,546	\$32,621
Persons in poverty, percent	10.4%	11.8%
<b>Businesses</b>		
Total employer establishments, 2018	12,870	7,912,405
Total employment, 2018	202,542	130,881,471
Total annual payroll, 2018	9,673,326	7,097,310,272
Total employment, percent change, 2017-2018	3.7%	1.8%
Total nonemployer establishments, 2018	33,976	26,485,532
<b>Geography</b>		
Population per square mile, 2010	66.9	87.4
Land area in square miles, 2010	6,302.37	3,531,905.43
FIPS Code	32031	1



# LOCAL SERVICES





# Quick Reference Guide

AT & T (Telephone & Internet)	800.331.0500	<a href="http://www.att.com">www.att.com</a>
NV Energy (Gas/Electric)	775.834.4444	<a href="http://www.nvenergy.com">www.nvenergy.com</a>
Waste Management (Garbage/Recycle)	775.329.8822	<a href="http://Www.wm.com">Www.wm.com</a>
Washoe County Public Utilities	775.954.4601	<a href="http://www.washoecounty.us/water">www.washoecounty.us/water</a>
Truckee Meadows Water Authority	775.834.8080	<a href="http://www.tmh2o.com">www.tmh2o.com</a>
Spectrum Communications	855.707.7328	<a href="http://www.charter.com">www.charter.com</a>
Reno Gazette Journal	800.970.7366	<a href="http://www.rgj.com">www.rgj.com</a>
City of Reno Sewer	775.334.2095	<a href="http://www.reno.gov">www.reno.gov</a>
City of Sparks Sewer	775.353.5555	<a href="http://www.cityofsparks.us">www.cityofsparks.us</a>
Department of Motor Vehicles	775.684.4368	<a href="http://www.dmvnv.com">www.dmvnv.com</a>
United States Post Office	800.275.8777	<a href="http://www.usps.com">www.usps.com</a>
Washoe County Library System	775.327.8327	<a href="http://www.washoecountylibrary.us">www.washoecountylibrary.us</a>
Washoe County School District	775.348.0200	<a href="http://www.washoeschools.net">www.washoeschools.net</a>
University of Nevada, Reno	775.784.1110	<a href="http://www.unr.edu">www.unr.edu</a>
Truckee Meadows Community College	775.673.7111	<a href="http://www.tmcc.edu">www.tmcc.edu</a>
Reno Police Dept (Non-Emergency)	775.334.2121	<a href="http://www.renospd.com">www.renospd.com</a>
Sparks Police Dept (Non-Emergency)	775.353.2231	<a href="http://www.sparkspd.com">www.sparkspd.com</a>
Nevada Highway Patrol	775.688.2500	<a href="http://www.nhp.nv.gov">www.nhp.nv.gov</a>
Reno Fire Dept (Non-Emergency)	775.334.2300	<a href="http://www.reno.gov/government/departments/fire-department">www.reno.gov/government/departments/fire-department</a>
Sparks Fire Dept (Non-Emergency)	775.353.2255	<a href="http://www.cityofsparks.us/departments/fire-department">www.cityofsparks.us/departments/fire-department</a>
Road Conditions	511 or 877.687.6237	<a href="http://www.nvroads.com">www.nvroads.com</a>
Washoe Co. Regional Animal Services	775.353.8900	<a href="http://www.washoecounty.us/animal">www.washoecounty.us/animal</a>
St. Mary's Hospital	775.770.3000	<a href="http://www.saintmarysreno.com">www.saintmarysreno.com</a>
Renown Medical Center	775.982.4100	<a href="http://www.renown.org">www.renown.org</a>
Northern Nevada Medical Center	775.331.7000	<a href="http://www.nnmc.com">www.nnmc.com</a>
VA Hospital	775.786.7200	<a href="http://www.reno.va.gov">www.reno.va.gov</a>
Washoe Co. Health Department	775.328.2400	<a href="http://www.washoecounty.us/health">www.washoecounty.us/health</a>
Washoe County Poison Center	800.222.1222	
Better Business Bureau	775.322.0657	<a href="http://www.bbb.org/reno">www.bbb.org/reno</a>



# Local Services

## UTILITIES ETC.

---

### **DMV**

Nevada Department of Motor Vehicles  
www.dmvnv.com  
775.684.4368

### **Electricity/Gas**

NV Energy  
775.834.4444

### **Garbage & Recycling**

Waste Management  
775.329.8822

### **Cable/Digital Television**

Communications Spectrum  
888.438.2427

### **Truckee Meadows Water Authority**

(Reno/Sparks)  
775.834.8080

### **Washoe County Water Resources**

775.954.4601

### **Sewer Service**

City of Reno - 775.334.2095  
City of Sparks - 775.353.5555

### **Telephone**

AT&T  
800.288.2020

### **Voter Registration**

Washoe County Registrar of Voters  
775.328.3670  
www.washoecounty.us/voters

### **Library**

Washoe County Public Libraries  
775.327.8300

### **Pet Licensing**

Washoe County Animal Control  
775.353.8900

### **United States Post Office**

Reno Main Office - 2000 Vassar  
Sparks Main Office - 750 4th Street  
800.275.8777

### **Newspapers**

Reno Gazette Journal  
775.788.6200  
www.RGJ.com

### **Sparks Tribune**

775.236.2087  
www.sparkstrib.com

### **Reno News & Review**

775.324.4440  
www.newsreview.com/reno

### **Moving In**

Apartment Guide  
800.216.1423  
www.apartmentguide.com

### **Reno-Sparks Association of Realtors**

775.823.8800  
www.rsar.net

## MEDICAL FACILITIES

---

### **Washoe County District Health**

775.328.2400  
www.washoecounty.us/health

### **VA Sierra Nevada**

1000 Locust St.  
775.786.7200  
www.reno.va.gov

### **CARE Chest of Sierra Nevada**

775.829.2273  
www.carechest.com

### **Centers for Disease Control & Prevention**

800.232.4636 - English

### **Northern Nevada Medical Center**

2375 E. Prater Way.  
775.331.7000  
www.nnmc.com

### **Saint Mary's Regional Medical Center**

235 W. 6th St.  
775.770.3000  
www.saintmarysreno.com

### **Renown Medical Center**

77 Pringle Way.  
775.982.4100  
www.renown.org

### **Renown Rehabilitation Hospital**

1495 Mill St.  
775.982.5000

### **Health Access Washoe County Clinic**

1055 S. Wells Ave.  
775.329.6300  
www.chanevada.org

### **Medicaid Information**

775.684.3600

### **National Cancer Institute**

800.422.6237

### **United Blood Services**

775.324.6454

### **University of Nevada School of Medicine Family Medicine Center**

1664 N. Virginia St.  
775.784.1533

### **US Dept of Health and Human Services**

**National Health Information**  
877.696.6775



# Childcare & Youth Services



## CHILDCARE

### **Discoveries Pre-School**

775.425.2273

### **El Cord Foundation Child Care Center**

775.674.7515

### **Hippity Hop Learning Center**

775.828.2928

### **Just Kidding Learning Center**

775.425.2210

### **Kid "R" Kids Learning Academy**

775.525.6738

### **Milestones Early Childhood Learning**

775.770.2269

### **McCarran Kindercare**

775.331.4211

### **Little Bear Preschool-Childcare**

775.358.4128

### **Montessori-Mountain View**

775.852.6162

### **One World's Children's Academy**

775.856.8339

### **Sierra Summit Children's Academy**

775.851.4769

### **The Goddard School**

*Sparks:* 775.626.5678

*Reno:* 775.853.0511

### **Treasure Chest Learning Center**

775.359.1122

### **University Preschool & Childcare**

775.329.7119

### **A + Learning Center**

775.825.2522

### **Blue Kangaroo Learning Center**

775.351.2583

### **The Child Garden-Preschool & Kindergarten**

775.322.3471

### **Imagination Station**

775.626.9292

## YOUTH SERVICES

### **Washoe County Social Services (licensing)**

775.785.8600

### **The Children's Cabinet**

775.856.6200

### **Education Alliance of Washoe County**

775.353.6950

### **Family Counseling Services**

775.329.0623

### **State of Nevada Division of Child & Family Services Placement**

775.684.4400

### **State of Nevada Welfare Division**

775.684.7200

### **Big Brothers Big Sisters of Northern Nevada**

775.352.3202



# Senior Resources



## IMPORTANT CONTACTS

---

### **Adult Daycare Program**

775.328.2591

### **Alzheimer's Association of Northern Nevada**

775.786.8061

### **American Association of Retired Persons**

775.328.2506

### **RTC Access**

775.348.5438

### **Elder Care Locator**

800.677.1116

### **Lend-a-Hand Senior Services**

775.322.8414

### **Social Security and Medicare Eligibility Information**

800.772.1213

### **Senior Companion Program**

775.358.2322

### **Washoe County Senior Services**

775.328.2575

### **Nevada State Division for Aging Services**

775.688.2964

### **Northern Nevada Center for Independent Living**

775.353.3599

### **Nevada Department of Health & Human Services**

775.684.4000

### **Veterans Administration Benefits/Info**

800.827.1000

### **VA Medical Center**

775.786.7200

### **Assisted Living**

Five Star Premier - 775.829.1050

MorningStar Senior Living of Sparks - 775.277.6264

### **Foster Grandparent Program**

775.686.5872

### **Retired Senior Volunteer Program**

775.686.5872

### **City of Reno Senior Connect**

775.657.4602

## SENIOR CENTERS

---

### **The Continuum**

3700 Grant Ave, Suite A

775.829.4700

### **Alf Sorensen Community Center**

1400 Baring Blvd.

775.353.2385

### **Reno Senior Center**

1155 E. 9th Street

775.328.2575

### **Reno-Sparks Indian Colony Senior Center**

34 Reservation Rd.

775.329.9929

### **Sparks Senior Center**

97 Richards Way

775.353.3110



# Pet & Animal Services



## VETERINARIANS

**Animal Emergency Center**  
775.851.3600

**VCA Feline Medical Center**  
775.829.0969

**Klaich Animal Hospital**  
775.826.1212

**Sage Veterinary Care**  
775.409.3288

**A-Plus Animal Hospital**  
775.852.4300

**Pyramid Veterinary Hospital**  
775.356.8323

**Desert Hills Animal Hospital**  
775.331.4700

**South Reno Veterinary Hospital**  
775.852.2244

**High Desert Equine Center**  
775.475.0100

**VCA Lakeside Animal Hospital**  
775.827.8866

**Animal Medical Center of Reno**  
775.827.3033

**Galena Veterinary Hospital**  
775.853.4003

## SHELTERS & RESCUE ORGANIZATIONS

**Nevada Humane Society**  
775.856.2000  
[www.NevadaHumaneSociety.org](http://www.NevadaHumaneSociety.org)

**Washoe County Animal Services**  
775.353.8900  
[www.washoecounty.us/animal](http://www.washoecounty.us/animal)

**SPCA of Northern Nevada**  
775.324.7773  
[www.SPCAnevada.org](http://www.SPCAnevada.org)



## KENNELS, BOARDING & DAYCARE

**The Bark House**  
775.359.2275

**Fantasia Pet Resort**  
775.322.1199

**Pet Play House**  
775.324.0202

**Animal Oasis**  
775.826.9911

**On Command Dogs**  
775.825.3647

**The Dog Park!**  
775.453.2667



## EQUESTRIAN CENTERS

**Reno Tahoe Equestrian Centre**  
775.853.1385

**Maplewood Stables**  
775.849.1849

**Franktown Meadows Equestrian Centre**  
775.849.1600

**Rancharrah-Equestrian Center**  
775.824.4305



## DOG PARKS



Sparks Marina Dog Park  
Rancho San Rafael  
Link Piazza Dog Park  
Biggest Little Dog Park  
Virginia Lake Dog Park



# Local Churches & Faith Centers



## **The Bridge Church**

1330 Foster Dr.  
775.323.7141

## **Center for Spiritual Living**

4685 Lakeside Dr.  
775.826.0566

## **The Church of Jesus**

Christ Latter Day Saints  
2000 Beaumont Pkwy.  
775.747.6688

## **Community Bible Church**

385 Gentry Way.  
775.358.8954

## **Congregation Temple Emanuel**

1031 Manzanita Ln.  
775.825.5600

## **Covenant Presbyterian Church**

6695 MaeAnne Ave.  
775.746.8118

## **First United Methodist Church**

209 W. 1st St.  
775.322.4564

## **Grace Community Church**

1220 Robb Dr.  
775.747.9000

## **Faith Alive Christian Center**

120 Hubbard Way.  
775.827.0333

## **The Little Flower Church**

875 E. Plumb Ln.  
775.322.2255

## **Lord of Mercy Lutheran Church**

9650 Pyramid Way.  
775.358.7863

## **Reno Assembly of God**

524 Bell St.  
775.323.7827

## **Reno Buddhist Center**

820 Plumas St.  
775.525.1182

## **Reno/Sparks Hispanic Seventh Day Adventist Church**

1555 Wedekind Rd.  
775.501.0027

## **River View Adventist Church**

7125 W 4th St.  
775.322.9642

## **The Rock Church**

4950 Vista Blvd.  
775.355.7888

## **St. Rose of Lima Catholic Church**

100 Bishop Manogue Dr.  
775.851.1874

## **St. Thomas Aquinas Cathedral**

310 W. Second St.  
775.329.2571

## **Sparks Nazarene Church**

2200 El Rancho Blvd.  
775.358.4066

## **Sparks Seventh Day Adventist**

2990 Rock Blvd.  
775.331.4332

## **Summit Christian Church**

7075 Pyramid Hwy.  
775.424.5683

## **Temple Sinai**

3405 Gulling Rd.  
775.747.5508

## **Trinity Episcopal Church**

200 Island Ave.  
775.329.4279

## **Unitarian Universalist Fellowship**

780 Del Monte Ln.  
775.851.7100

## **The Springs Lutheran Church**

470 Rockwell Blvd.  
775.354.2800

## **Immaculate Conception Church**

2900 N. McCarren Blvd.  
775.358.5977



# Health Clubs

## FITNESS FACILITIES

**Sports West Athletic Club**  
1575 S Virginia St.  
775.348.6666

**South Reno Athletic Club**  
9393 Gateway Dr.  
775.853.4050

**Double Diamond Athletic Club**  
9400 Double Diamond Pkwy.  
775.851.7171

**Flex Appeal**  
1101 Steamboat Pkwy. #350  
775.852.3539

**American Iron Gym**  
650 S Rock Blvd.  
775.856.4766

**European Fitness Center**  
2999 S Virginia St.  
775.826.4711

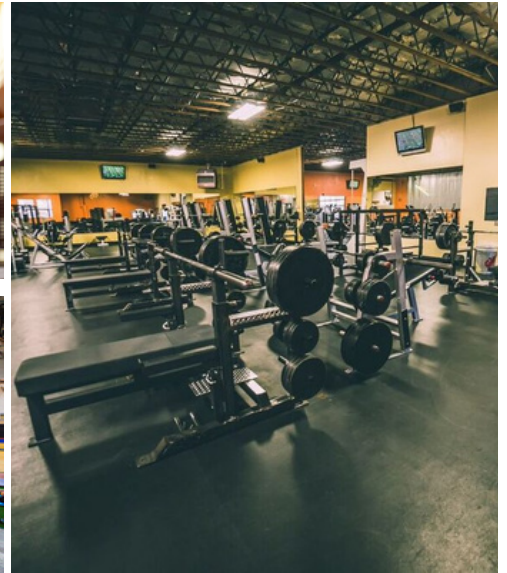

## GROUP TRAINING

**Double Edge Fitness– South**  
6450 S Virginia St.  
775.357.8363

**UFC Gym Reno**  
4875 Kietzke Ln. Ste D  
775.285.9340

**EVOKE Fitness Training Complex**  
895 E Patriot Blvd. Suite 108  
775.827.1995

**F.A.S.T**  
1351 Corporate Blvd.  
775.771.0788

**Orange Theory Fitness Reno**  
8056 S Virginia St. #1  
775.800.2308  
1575 Robb Dr. #1  
775.800.5515

**Double Edge Fitness– Midtown**  
1065 S Virginia St.  
775.657.9956

**9Round Fitness**  
748 S. Meadows Pkwy #A7  
775.420.5960

**Results Transformation Center**  
Sparks– 670 Greenbrae Dr. Suite 140  
775.360.5776

**Studio Sculpt Reno**  
6135 Lakeside Dr. #137  
775.219.6000

**West Reno Fit Body Boot Camp**  
973 W Moana Ln.  
775.313.1151

**Camie Craig Fitness**  
3865 Mira Loma Dr.  
775.825.2231

**Mind Body & Pilates**  
615 Sierra Rose Dr. #2b  
775.745.4151

**Pure Barre**  
South Reno:  
748 S. Meadows Pkwy. #A6  
775.815.3244

North Reno: 5110 MaeAnne Ave. #701  
775.413.9665





# Transportation

## **Reno/Tahoe International Airport**

2001 E. Plumb Ln.  
775.328.6400  
[www.renoairport.com](http://www.renoairport.com)

## **Carson City Airport**

2600 E College Pkwy.  
775.841.2255  
[www.flycarsoncity.com](http://www.flycarsoncity.com)

## **South Lake Tahoe Airport**

1901 Airport Rd.  
530.541.0484  
[www.laketahoeairport.com](http://www.laketahoeairport.com)

## **Amtrak**

280 N Center St.  
775.329.8638  
\*Reno offers railroad service for passengers and freight\*

## **Greyhound Bus Line**

155 Stevenson St.  
775.322.2970  
\* Greyhound Bus Lines operate throughout the country and have many services in and out of Reno.  
\* Citifare Public Bus Line provides local transportation throughout Reno year round.

## **Regional Transportation Commission**

775.348.7433  
[www.rtcwashoe.com](http://www.rtcwashoe.com)

## **Taxi Service**

Reno Sparks Cab Co. - 775.333.3333  
Whittlesea Taxi - 775.322.2222  
Yellow Cab Company - 775.355.5555





# THINGS TO DO





# Special Events

Reno/Sparks is home to the Reno/Tahoe Open, Hot August Nights, Reno Rodeo, Reno Championship Air Races, Great Reno Balloon Races, The National Bowling Stadium, and Shakespeare at Lake Tahoe and the home of The Reno Aces AAA Baseball Team. Other events include Cinco de Mayo Celebration, The Great Italian Festival and Street Vibrations and the counter-cultural festival, Burning Man held in the Black Rock Desert 90 miles north.

Reno/Sparks/Tahoe is the cultural center of the Sierra's. The arts are alive with the area's own Philharmonic Orchestra, Chamber Orchestra and the annual UNR Jazz Festival. One of the area's most successful events is ARTown, which has grown in to one of the largest visual and performing festivals in the country because of the events that take place during the entire month of July.

Reno/Sparks/Tahoe's natural beauty and its distinctive four season climate combine to offer almost every type of recreational activity. The majestic Sierra Nevada mountains form the western boundary of the Truckee Meadows features Alpine and Nordic skiing at 18 major resorts. Fishing, sailing, swimming, hiking, biking, camping and horseback riding are all exceptional and less than half an hour away in the numerous mountains or desert lakes surrounding the Reno/Sparks/Tahoe area.

**For event location and details, visit [www.visitrenotahoe.com](http://www.visitrenotahoe.com).**





# 2021 Special Events

## January

The Sheep Show  
Brew HaHa

## February

SCI Annual Hunter's Convention  
Alpenglow Sports Mountain Festival  
Snowfest!

## March

Rocky Mountain Oyster Fry  
Monster Jam  
Leprechaun Race  
WinterWonderGrass Tahoe

## April

Reno Jazz Festival  
Virginia City Grand Prix

## May

Reno River Festival  
Biggest Little Half Marathon  
Hot August Nights Spring Fever Revival  
Reno-Tahoe Odyssey

## June

Street Vibrations Spring Rally  
Reno Rodeo  
Great Eldorado BBQ, Brews & Blues  
Reno Ukulele Festival  
Nevada State Fair  
Reno Art Fest

## July

Artown  
Star Spangled Sparks  
Biggest Little City Wing Fest  
Barracuda Championship

## August

Hot August Nights  
Northern Nevada Dragon Boat Festival  
Burning Man

## September

Best in the West Nugget Rib Cook-Off  
Virginia City International Camel Races  
Annual Great Reno Balloon Races  
National Championship Air Races  
Street Vibrations Fall Rally  
Genoa Candy Dance

## October

Great Italian Festival  
Nevada Day Parade

## November

Crafts for Christmas

## December

Sparks Hometown Christmas  
Nevada Chamber Music Festival

For a complete list of events:  
[www.visitrenotahoe.com](http://www.visitrenotahoe.com)



# Golf Courses



## PRIVATE

### Arrowcreek Country Club

2905 Arrowcreek Pkwy  
775.850.4653  
golfarrowcreek.com

### Montreux Golf & Country Club

16475 Bordeaux Drive  
775.849.1090  
montreuxgolf.com

### Toiyabe Golf Course

19 Lightning W Ranch Road  
775.882.0882  
duncangolfreno.com

### Hidden Valley Country Club

3575 E. Hidden Valley  
775.857.4735  
hvccreno.com

### The Private Club at Redhawk

6295 Wingfield Springs  
775.626.6000  
redhawkgolfandresort.com

### Somerset Country Club

2019 Championship Trail  
775.787.1800  
Somersetgolfandcountryclub.com

## PUBLIC

### Sierra Sage Golf Course

6355 Silver Lake Road  
775.972.1564  
sierrasagegolf.org

### Washoe County Golf Course

2601 Foley Way  
775.828.6633  
washoegolf.org

### Lakeridge Golf Course

1218 Golf Club Drive  
775.825.2200  
lakeridgegolf.com

### Wolf Run Golf Club at Fieldcreek

1400 Wolf Run Road  
775.851.3301  
wolfrungolfclub.com

### Wildcreek Golf Course

3500 Sullivan Lane  
775.673.3100  
wildcreekgolf.com





# Winter Recreation

The Reno / Lake Tahoe region has a wide variety of top cross-country skiing areas, downhill ski resorts, and snow play areas. Sprinkled around the Lake Tahoe area, these winter sports areas are blessed with abundant snow, excellent accommodations, and easy access from Reno, Sacramento, and the Bay Area. In addition to downhill and cross-country skiing, winter sports opportunities include snowshoeing, sledding, snow tubing, and snowmobiling.

## Cross Country Skiing

### Caples Lake Resort

1111 Highway 88, Kirkwood, CA  
209.258.8888  
www.capleslakeresort.com

### Sorensen's Resort

14255 Highway 88, Hope Valley, CA  
530.694.2203 / 800.423.9949  
www.sorensensresort.com

### Royal Gorge Cross Country

9411 Pahatsi Rd. Soda Springs, CA  
530.426.3871  
www.royalgorge.com

## Snowmobiling

### Lake Tahoe Adventures

South Lake Tahoe, CA  
530.577.2940 / 800.865.4679  
www.laketahoadventures.com

### Zephyr Cove Snowmobiling Center

760 Hwy 50, Zephyr Cove, NV  
775.588.4906 / 800.238.2463

## SLEDDING, SNOWSHOEING ETC.!

- Tahoe Donner Snow Play Area-** (530) 587-9437 - 11509 Northwood in Truckee
- Squaw Valley USA-** (530) 425-4000 - south of Truckee on Highway 89
- Soda Springs Snow Park-** (530) 426-3901 - 180 at Soda Springs exit
- Sugar Bowl Sledding & Snow Play -** (530) 426-9000 - 180 at Soda Springs exit
- Northstar at Tahoe -** (530) 562-2013 - south of Truckee on Highway 267
- Heavenly Adventure Peak Snow Park** (775) 586-7000 - South Lake Tahoe
- Boreal's Tubing Park -** (530) 426-3666 - 180 at Donner Summit
- Hansen's Resort-** (530) 544-3361 - South Lake Tahoe
- Granlibakken's Sledhill-** (800) 543-3221 - Tahoe City, west shore Lake Tahoe
- Kingvale Sledding and Tubing Park -** (916) 622-6654 - 180 at Kingvale exit
- Woodward Tahoe -** (530) 426-1114 - 19749 Boreal Ridge - Soda Springs
- Hope Valley Outdoors-** (530) 721-2015- Pickett's Junction, SR-88 and SR-89



# Tahoe Area Resorts

	<u>Elevation</u>	<u>Terrain (Acres)</u>	<u>Vertical Drop</u>	<u>Chairlifts</u>	<u>Lessons</u>	<u>Beginner Runs %</u>	<u>Intermediate Runs %</u>	<u>Advanced Run %</u>	<u>Website</u>
Alpine Meadows (530) 583-4232	8,637'	2,400	1,802'	13	yes	24	40	35	sqawalpine.com
Boreal (530) 426-3666	7,700'	380	500'	8	yes	30	55	15	rideboreal.com
Diamond Peak (775) 832-1177	8,540'	655	1,840'	7	yes	18	46	36	diamondpeak.com
Donner Ski Ranch (530) 426-3635	7,781'	460	750'	6	yes	25	50	25	donnerskiranch.com
Granlibakken (800) 543-3221	6,300'	7	300'	2	yes	60	40	0	granlibakken.com
Heavenly Mountain Resort (800) HEAVENLY	10,067'	4,800	3,500'	28	yes	20	45	35	skiheavenly.com
Homewood Mountain Resort (530) 525-2992	7,880'	1,260	1,650'	8	yes	15	50	35	skihomewood.com
Kirkwood Mountain Resort (877) KIRKWOOD	9,800'	2,300	2,000'	15	yes	12	30	58	kirkwood.com
Mt. Rose (775) 849-0704	9,700'	1,200+	1,800'	8	yes	20	30	50	skirose.com
Northstar California 1800-go-north	8,610'	3,170	2,280'	20	yes	25	60	27	northstarcalifornia.com
Sierra-at-Tahoe (530) 659-7453	8,852'	2,000	2,212'	14	yes	25	50	25	sierraattahoe.com
Soda Springs (530) 426-3901	7,300'	200	550'	5	yes	30	40	30	skisodasprings.com
Squaw Valley USA (530) 452-4000	9,050'	3,600	2,850'	29	yes	25	45	30	squawalpine.com
Sugar Bowl (530) 426-9000	8,383'	1,650	1,500'	13	yes	17	45	38	sugarbowl.com
Tahoe Donner (530) 587-9444	7,350'	120	600'	4	yes	40	60	0	tahoedonner.com

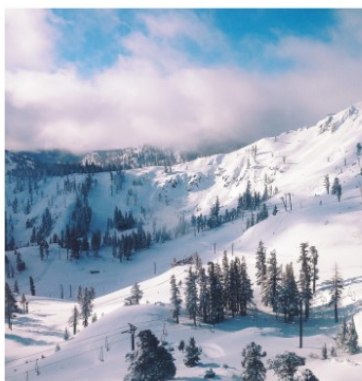



# Parks & Recreation

## **Truckee River Walk**

Features native Nevada wildlife relief's and unique fountains year-round. The River walk is a perfect place to take a leisurely stroll and take in the beauty that surrounds downtown Reno.

## **Sand Mountain**

Sand Mountain is a dune over 328 feet high located about 2 hours from Reno. It is popular with camping and off- road vehicle enthusiasts.

## **Sparks Marina**

This 77-acre lake with year round picnicking, fishing, jogging trails and children's playground. A family beach, volleyball courts and a dog park.

## **Rancho San Rafael**

The Wilbur D. May Arboretum and Botanical Garden ~ one of the most beautiful and diverse gardens in Nevada. Twelve acres covered with groves of trees, wetland habitats, outdoor courtyards and secluded gardens.

## **Bartley Ranch Regional & Robert Z. Hawkins Amphitheater**

Consisting of 56 acres of scenic pasture, walking trails, a regulation size horse arena and warm-up area, the Western Heritage Interpretive Center and the Old Huffaker School.

## **Galena Creek Recreation Area**

The center includes a weather station, exhibits, gift shop and book store. A half-mile paved nature trail is located just outside the Visitor Center along with access to the Jones-Whites Creek Loop Trail and the Mt. Rose Wilderness. The Recreation Area has individual picnic areas and one large group picnic area and a new trailhead.

## **Lazy 5 Regional Park**

This park includes a 2,400 sq. ft. community center with outdoor patio and barbecue area, a water play park, two playgrounds, volleyball courts, horseshoe pits and two multi-use athletic fields.

## **Bowers Mansion Park**

The Stately Bowers mansion is located in the center of the park and offers a rare glimpse into Nevadan life in the 1860's. The park also includes an outdoor swimming pool, playground, group and individual picnic areas.

## **Golden Eagle Regional Park & Sports Complex**

This large outdoor artificial turf sports complex in Sparks, Nevada has 1.4 millions square feet of turf which currently makes it to be the largest single installation artificial turf project in North America.

City of Reno Parks & Recreation - 775.334.2262  
[www.cityofreno.com](http://www.cityofreno.com)

Sparks Parks & Recreation Department - 775.353.2376  
[www.cityofsparks.us/living/parks\\_rec](http://www.cityofsparks.us/living/parks_rec)

Washoe County Parks and Recreation - 775.828.6642  
[www.co.washoe.nv.us/parks](http://www.co.washoe.nv.us/parks)



# Nevada State Parks



Camping, fishing, hiking, swimming, nature study, star-gazing—not your thing? How about mountain biking, horseback riding, boating, water skiing, snowshoeing, ice-skating? Choose your favorite outdoor activity and Nevada State Parks will provide a place for it. Nevada’s 23 state parks, recreation areas and historic sites are stretched across terrains as diverse as alpine forests and bone-dry deserts. Among them are natural lakes and man-made reservoirs, such as world-famous, 22 mile long Lake Tahoe or the much smaller Echo Canyon and its 35-acre reservoir.

Other parks provide glimpses into the past. Valley of Fire is one of the state’s oldest, with 3,000-year-old petroglyphs carved in sandstone and breathtaking views of the maroon-colored rock formations created during the age of the dinosaurs. Mormon Station in Genoa and the Old Las Vegas Mormon Fort feature replicas of 19th-century fortifications and visitor centers explaining regional history.

Many campgrounds and RV facilities are open all year, depending on the weather. You can even stay in a yurt at Cave Lake State Park near Ely. Trailheads are well marked, and facilities at many parks include RV dump stations, showers and day use facilities for groups. For more information on Off-highway Vehicles (OHV) registration, go to Department of Motor Vehicles at [dmv.nv.com](http://dmv.nv.com).

*Beaver Dam State Park*  
*Berlin-Ichthyosaur State Park*  
*Big Bend of the Colorado State Recreation Area*  
*Cathedral Gorge State Park*  
*Cave Lake State Park*  
*Dayton State Park*  
*Echo Canyon State Park*  
*Elgin Schoolhouse State Historic Site*  
*Fort Churchill State Historic Site*  
*Fort Churchill State Historic Park*  
*Kershaw-Ryan State Park*  
*Lahontan State Recreation Area*  
*Lake Tahoe Nevada State Park*  
*Sand Harbor*  
*Spoooner Backcountry*  
*Cave Rock*

*Mormon Station State Historic Park*  
*Old Las Vegas Mormon Fort State Historic Park*  
*Rye Patch State Recreation Area*  
*South Fork State Recreation Area*  
*Spring Mountain Ranch State Park*  
*Spring Valley State Park*  
*Valley of Fire State Park*  
*Ward Charcoal Ovens State Historic Park*  
*Washoe Lake State Park*  
*Wild Horse State Recreation Park*





# Places to Eat



## FINE DINING

### Beaujolais Bistro

753 Riverside Dr.  
775.323.2227

### Bistro Napa @ the Atlantis

3800 S. Virginia St.  
775.335.4539

### Bricks

1695 S. Virginia St.  
775.786.2277

### Redwood Rotisserie & Grill

860 E Plumb Ln.  
775.824.9564

### Charlie Palmers @ Grand Sierra

2500 E. Second St.  
775.789.2456

### La Strada

345 N Virginia Ave.  
775.348.9297

### Western Village Steakhouse

815 Nichols Blvd.  
775.331.1069

### Romanza Ristorante Italiano

Peppermill Hotel & Casino  
866.821.9996

### The Steakhouse @ The Nugget

1110 Nugget Ave.  
775.356.3300

### LuLou's Restaurant

1470 South Virginia St.  
775.329.9979

### Rapscallion Seafood House

1555 South Wells Ave.  
775.323.1211

### Wild River Grille & River Room

17 S. Virginia St.  
775.284.7455

## LOCAL FAVORITES

### Buenos Grill

3892 Mayberry Dr.  
775.787.8226

✓ Dine-in | ✓ Takeout | ✓ Delivery

### Campo Reno

50 N Sierra St.  
775.737.9555

✓ Dine-in | ✓ Takeout | ✗ Delivery

### The Cheese Board

247 California Ave.  
775.323.3115

✗ Dine-in | ✓ Takeout

### The Brewer's Cabinet

475 S Arlington Ave.  
775.348.7481

✓ Dine-in | ✓ Takeout | ✗ Delivery

### The Depot

325 E 4th St.  
775.737.4330

✓ Dine-in | ✓ Takeout | ✗ Delivery

### Noble Pie Parlor

Midtown: 777 S Center St. #100  
775.323.1494

Downtown: 239 W 2nd St.  
775.622.9222

Summit: 13979 S. Virginia St. #505  
775.298.1261

✓ Dine-in | ✓ Takeout

### Great Full Gardens

Midtown: 555 S Virginia St.  
775.324.2013

South Meadows: 748 S Meadows Pkwy#A14  
775.324.2016

Sparks: "Outlets at Legends"  
775.440.1663

✓ Dine-in | ✓ Takeout | ✓ Delivery

### Great Basin Brewery

Sparks: 846 Victorian Ave.  
775.355.7711

Reno: 5525 S Virginia St.  
775.284.7711

✓ Dine-in | ✓ Takeout | ✗ Delivery

### Louis' Basque Corner

301 E. 4th St.  
775.323.7203

### Moxie's Spirits & Dining

6275 Sharlands Ave.  
775.747.2665

✓ Dine-in | ✓ Takeout | ✗ Delivery

### Old Granite Street Eatery

243 S. Sierra St.  
775.622.3222

✓ Dine-in | ✓ Takeout | ✗ Delivery

### Sup

669 S Virginia St.  
775.324.4787

✗ Dine-in | ✓ Takeout | ✗ Delivery

### Palais De Jade

960 West Moana Ln.  
775.827.5233

✓ Dine-in | ✓ Takeout | ✓ Delivery

### Pinocchio's

Sparks: 4820 Vista Blvd.  
775.626.0101

Reno: 5995 S Virginia St.  
775.826.5151

✓ Dine-in | ✓ Takeout | ✗ Delivery

### Silver Peak on the River

135 N. Sierra St. Ste E  
775.284.3300

✓ Dine-in | ✓ Takeout | ✗ Delivery

### ZoZo's Ristorante

3446 Lakeside Dr.  
775.829.9449

✓ Dine-in | ✓ Takeout | ✗ Delivery

### Pine State Biscuits

200 S Center St.  
775.432.2464

✓ Dine-in | ✓ Takeout | ✓ Delivery





# Shopping

**From the spectacular to the sublime, Reno/Sparks has the boutiques, retail stores, shopping malls, and outlet stores you need. Whether you're the most finicky bargain hunter or the biggest spender, whatever you're looking for, you'll find it in Reno/Sparks!**

## **The Legends at Sparks Marina**

In Reno's sister city resides the Legends at Sparks Marina, which offers outlet shopping, dining and entertainment is located off I-80. The Legends is anchored by Scheels, the World's Largest All Sports Store. The complex also features an array of top brand outlet stores, many exclusive to the Northern Nevada region. Outlet retailers include: Adidas, Banana Republic, Bath & Body Works, Carters, Converse, Forever21, Gamestop, GNC, Grimaldi's Pizzeria, Gymboree, Guess, Harry & David, Kenneth Cole, Lane Bryant, Nike, Nine West, Off Broadway Shoes, OshKosh, Vans, Volcom to name just a few.

## **The Summit**

Located at the south end of Reno at Mt. Rose Highway, The Summit is an open-air lifestyle shopping center with more than 70 shops specialty retailers, salons and restaurants. Its many courtyards feature fountains, paths and fire pits to gather around on cool evenings. Retailers include: Apple, Bath & Body Works, Buckle, Cache, Charlotte Russe, Coach, Dillard's, Guess, Hollister, J. Crew, Jared "The Galleria of Jewelry", Lucky Brand Jeans, M·A·C Cosmetics, PACSUN, Pottery Barn, Sephora, Tilly's, Vans, Victoria's Secret, White House | Black Market, Williams-Sonoma, and more.

## **Meadowood Mall**

Meadowood Mall, a longtime favorite, is located right in the middle of Reno. Meadowood Mall in southwest Reno features hundreds of popular stores, including names like JCPenney, Macy's, Sears, Body Shop, Express and Dick's Sporting. Clothing stores like American Eagle, are included alongside popular Victoria's Secret, Sephora and Bath & Body Works. The mall has jewelry stores, bookstores, shoe stores, electronics stores, home furnishings stores, an extensive food court and even a salon. Dick's Sporting Goods is the newest major tenant in Meadowood.

## **Cabela's**

Cabela's stores are known as premier shopping and tourism destinations, drawing visitors from hundreds of miles to indulge in a unique shopping experience that celebrates nature and the lifestyle of the outdoor enthusiast.

## **Truckee River Arts District**

Want to cater to your inner culture enthusiast? Located in close proximity to Reno's Truckee River Whitewater Park is the Truckee River Arts District. Both the CalAve and Riverwalk sections of the district feature unique shopping excursions to specialty shops, antique stores, boutiques, galleries and unique culinary attractions. This area is quickly becoming Reno's preeminent neighborhood retail, restaurant, entertainment and business district. No big box stores here in this newest, hippest section of Reno.

## **Mayberry Landing Shopping Center**

A shopping oasis with a collection of 19 unique shops and restaurants. Mayberrylanding offers a variety of specialty stores. Including: gift shops, wine stores, restaurants, spas, hair salons, pet stores, dry cleaning, pilates, art classes and even music lessons!

## **Midtown Boutiques**

The MidTown District has become the most compelling shopping area in Reno with a variety of locally owned wine bars, coffee shops, restaurants, and spas. Midtowns shops display originality that stands out compared to any other market.



# Fun Stuff for Kids

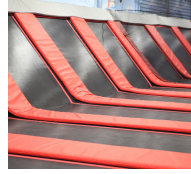
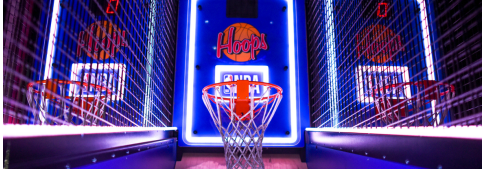

## **Animal Ark Zoo**

775.970.3111, animalark.org

## **Atlantis Family Fun Center**

775.825.4700

## **Base Camp @ Whitney Peak**

775.398.5400, basecampreno.com

## **Boomtown Family Fun Center**

775.345.6000, boomtownreno.com

## **Boy Scouts - Nevada Area Council**

775.787.1111

## **Cold Springs Park (skate park)**

775.785.4512

## **EZ Air Indoor Trampoline Park**

775.853.1200, ezairsports.com

## **Fleischmann Planetarium**

775.784.4812

## **Galaxy Imax Theater**

775.343.7638

## **Girl Scouts of Nevada**

775.322.0642

## **Grand Sierra Fun Quest Center**

775.789.1127

## **Grand Sierra Aqua Driving Range**

775.789.2122

## **Idlewild Pool & Playland**

775.334.2267

## **Jump Man Jump**

775.856.3226, www.jumpmanjump.com

## **Junior Achievement of Northern Nevada**

775.323.8084

## **Magic Carpet Golf**

775.853.8837, magiccarpetgolfreno.com

## **Nevada Discovery Museum**

490 S Center Street

775.786.1000, www.nvdm.org

## **Need 2 Speed Indoor Go-Cart Track**

775.851.7223, need2speed.com

## **Northwest Pool**

775.334.2203

## **Rattlesnake Mountain Skate Park**

@ Mira Loma Park

775.334.2417

## **Reno Indoor Paintball**

775.342.5477, renoindoorpaintball.com

## **Rocksport Indoor Climbing Center**

775.352.7673

## **Roller Kingdom**

775.329.3472

## **Sierra Safari Zoo**

775.677.1101

## **Truckee Meadows Boys & Girls Club**

775.331.5437

## **Ultimate Rush Speed & Thrill Park**

775.786.7005

## **Wild Island Family Adventure Park/Coconut Bowl**

775.359.2927, wildisland.com

## **Wilbur D. May Center**

775.785.5961,

Www.washoecounty.us/parks/  
maycenterhome

## **Wasting Arrows**

775.360.6556

wastingarrows.com

## **Urban Air Trampoline and Adventure Park**

775.300.7607

## **Fly High**

775.856.8131

## **Puzzle Room**

775.525.5576

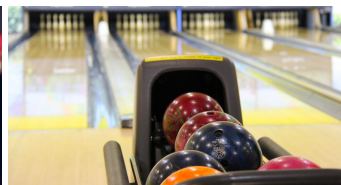

# First Centennial Title Company



On February 15, 1978, First Centennial Title Company opened its doors with a manager, one escrow officer, a title searcher, a bookkeeper, and a receptionist. **First Centennial Title** was affiliated with Centennial Title Resource out of San Diego, California. At the time of opening we were told by our competitors that we would never survive the Nevada business climate, as the industry was at its lowest point in years and we were competing with nine other title companies in the area. **First Centennial** has enjoyed many years of success since then.

In 1983, **First Centennial Title** of Nevada separated from the San Diego office and took over the building and business of Valley Title along with keeping their own name, clients and employees.

On March 1, 2001, **First Centennial** joined the Orange Coast Title Family of Businesses. Orange Coast Title brought its corporate support including technology and E-commerce initiatives to **First Centennial**. Orange Coast is one of the most successful privately held companies serving the Commercial and Residential real estate markets.

**First Centennial Title**, a full service title and escrow company, has grown from a one-office operation to a multi-office operation, with Branches in Reno, Sparks, Carson City, Incline Village and Stateline. Through the dedication of employees and direction of management, **First Centennial Title** has not only survived but has also flourished.

## MISSION STATEMENT



**FIRST CENTENNIAL TITLE IS YOUR PREEMINENT PROVIDER OF TITLE AND ESCROW SERVICES IN NORTHERN NEVADA. OUR EXPERIENCED TEAM IS COMMITTED TO BRINGING COMPREHENSIVE SOLUTIONS THROUGH OUR "IN IT TO CLOSE IT" CULTURE. WITH UNSURPASSED RESOURCES WE CREATE PEACE OF MIND MAKING YOUR REAL ESTATE EXPECTATIONS A REALITY.**

### **RENO MAIN**

1450 Ridgeview Dr. Suite 100  
Reno, NV 89519  
Phone: 775.689.8510  
Fax: 775.689.8520

### **PLAZA**

3700 Lakeside Dr. #110  
Reno, NV 89509  
Phone: 775.689.1810  
Fax: 775.800.5701

### **LAKESIDE**

3748 Lakeside Dr. #100  
Reno, NV 89509  
Phone: 775.689.8235  
Fax: 775.800.5700

### **DAMONTE RANCH**

500 Damonte Ranch Pkwy. Suite 820  
Reno, NV 89521  
Phone: 775.737.5090  
Fax: 775.571.1441

### **SPARKS**

4870 Vista Blvd. #110  
Sparks, NV 89436  
Phone: 775.689.8551  
Fax: 775.507.3998

### **CARSON CITY**

896 W. Nye Ln. # 104  
Carson City, NV 89703  
Phone: 775.841.6580  
Fax: 775.507.3995

### **INCLINE VILLAGE**

937 Tahoe Blvd. #130  
Incline Village, NV 89451  
Phone: 775.831.8200  
Fax: 775.507.3996

### **ZEPHYR COVE**

212 Elks Point Rd. #107  
Zephyr Cove, NV 89448  
Phone: 775.841.6580  
Fax: 775.507.3995